

POWERFLEX®

PART NUMBER

PFF19-1101

DESCRIPTION

FRONT WISHBONE FRONT BUSH

INSTALLATION GUIDE

Contents (parts per pack):

2 x A Polyurethane Bushes 2 x B Polyurethane Bushes
2 x Stainless Steel Sleeves 1 x PTFE/Silicone Grease
2 x Mild Steel Washers

Please read the complete fitting instructions and check package components before fitment. These fitting instructions are to be used as a guide and in conjunction with workshop manual.

It is recommended that:

- all work to be carried out by a licensed technician;
- all safety precautions adhered to;
- wheel alignment to be checked and adjusted as required after any suspension work.
- All fasteners must be tensioned to manufacturer's torque settings.



Fitting Instructions:

1. Remove the wishbone from the vehicle.
2. Remove the original rubber bush from the wishbone.
3. Clean away any dirt and corrosion from the bore of the wishbone, using a rounded file to remove any sharp edges to prevent damaging the new bush.
4. Press the thicker A Bush into the wishbone facing towards the front of the vehicle.
5. Press the thinner B Bush into the other side of the wishbone.
6. Apply some of the supplied grease to the bore and end face of each bush.
7. Insert the stainless steel sleeve into the bore of the bush.
8. Place the plated washer onto the end face of the A Bush shown in Fig 2, at the point of presenting the wishbone to the subframe.
9. Refit the wishbone to the vehicle and tension all hardware to the manufacturer's recommended torque settings.

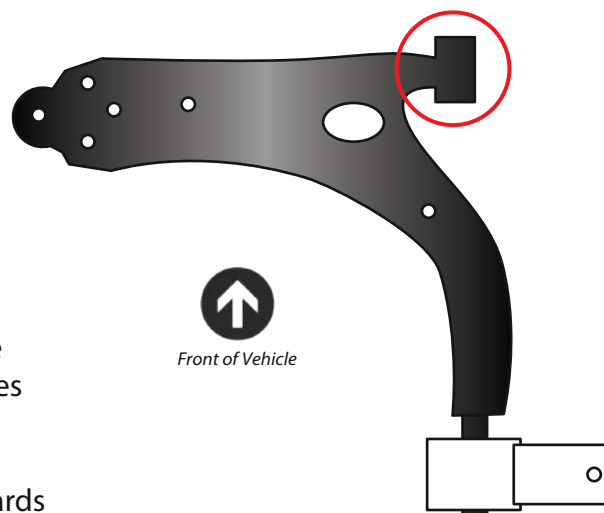

Figure 1

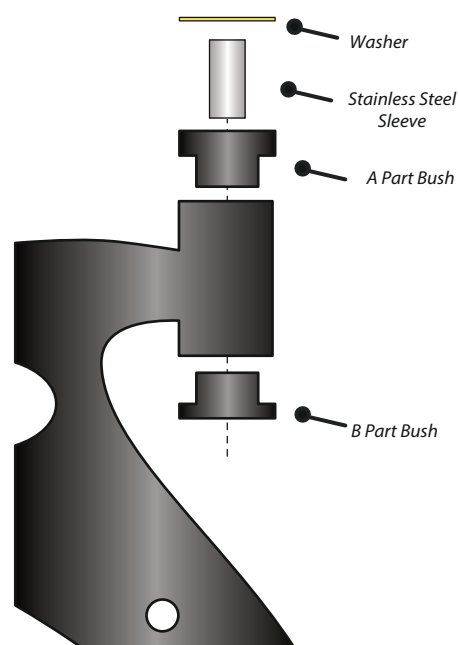

Figure 2