

POWERFLEX®

PART NUMBER

PFF5-402

DESCRIPTION

FRONT TRACK CONTROL ARM INNER BUSH

INSTALLATION GUIDE

Contents (parts per pack):

2 x Polyurethane Bushes 1 x PTFE/Silicone Grease
2 x Stainless Steel Washers 2 x Stainless Steel Sleeves

Please read the complete fitting instructions and check package components before fitment. These fitting instructions are to be used as a guide and in conjunction with workshop manual.

It is recommended that:

- all work to be carried out by a licensed technician;
- all safety precautions adhered to;
- wheel alignment to be checked and adjusted as required after any suspension work.
- All fasteners must be tensioned to manufacturer's torque settings.

Fitting Instructions:

1. Remove the original rubber bush from the arm, cleaning any away dirt or corrosion from the bore. Remove any sharp edges or burrs with a rounded file.

2. Press the polyurethane bush into the bore of the arm until fully through and so that both lips sit on the outside of the arm securely.

Tip: If you are having trouble pressing the bush in, try pressing the bush in at a slight angle so that one part of the lip is already in the bore of the shell, and when steady pressure is applied, the rest of the lip should follow.

3. Place the flat washer onto the stainless steel sleeve until it sits flush against the machined shoulder of the sleeve as shown in Fig 1.

4. Apply some of the supplied grease to the outer surface of the sleeve and the bore of the bush.

5. Press the sleeve into the bush until the washer sits flush against the bush face.

6. Fit the machined stainless steel washer onto the exposed end of the sleeve with the larger shoulder sitting against the bush face as shown in Fig 1.

7. Refit the arm to the vehicle ensuring the sleeve fits into the subframe as shown in Fig 2.

8. Tighten all hardware to the manufacturers recommended torque settings.



FRONT OF CAR

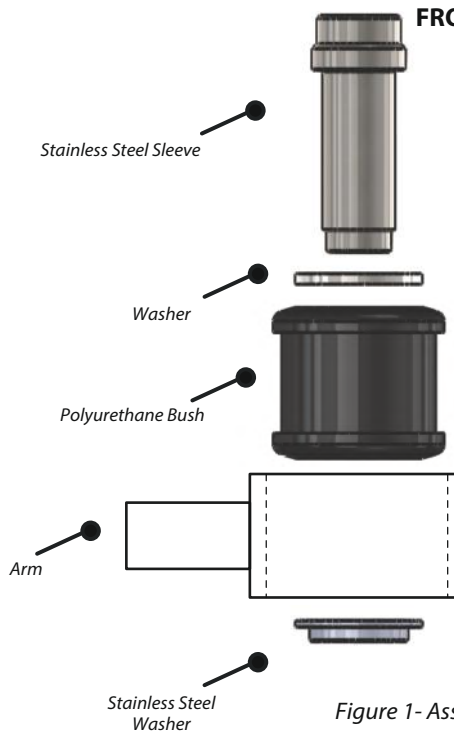

Figure 1 - Assembly



FRONT OF CAR

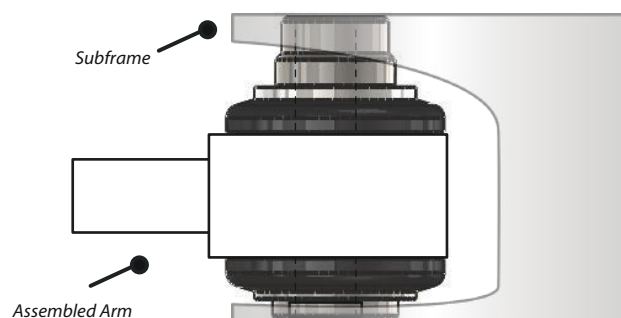

Figure 2 - Fitting the arm