

POWERFLEX®

PART NUMBER

PFF50-306

DESCRIPTION

LOWER REAR ENGINE MOUNT BUSH

INSTALLATION GUIDE

Contents (parts per pack):

- | | |
|-----------------------------|-----------------------------|
| 2 x Polyurethane Bushes | 2 x Mild Steel Outer Shells |
| 2 x Stainless Steel Sleeves | 4 x Washers |
| 1 x PTFE/Silicone Grease | |

Please read the complete fitting instructions and check package components before fitment. These fitting instructions are to be used as a guide and in conjunction with workshop manual.

It is recommended that:

- all work to be carried out by a licensed technician;
- all safety precautions adhered to;
- wheel alignment to be checked and adjusted as required after any suspension work.
- All fasteners must be tensioned to manufacturer's torque settings.

Fitting Instructions:

1. Support the engine with a trolley jack or hydraulic transmission stand.
2. Remove the torque mount fork from the vehicle.
3. Remove the lower engine mount bush including its outer shell from the engine mounting bracket. This can be done by cutting it out or using some sort of puller.
4. Clean any dirt and corrosion from the bore of the mount, removing any sharp edges or burrs around the mouth of the mount with a rounded file.
5. Press the bush into the mount with the stepped channel aligned in the direction of the receiving torque mount fork.

Tip: To ease fitment, apply a small amount of washing-up liquid to the bush and bore of the mount prior to assembly

6. Insert the PU sleeve (B part) into the bore of the large bush.
7. Apply some of the supplied grease to the bore of the PU sleeve and insert the stainless steel sleeve.
8. When refitting the torque arm fork to the vehicle, ensure that the supplied washers are placed on either side of the bush between the bush face and fork.
9. Tension all hardware to the manufacturer's recommended torque settings.
10. Remove the supporting jack/stand.

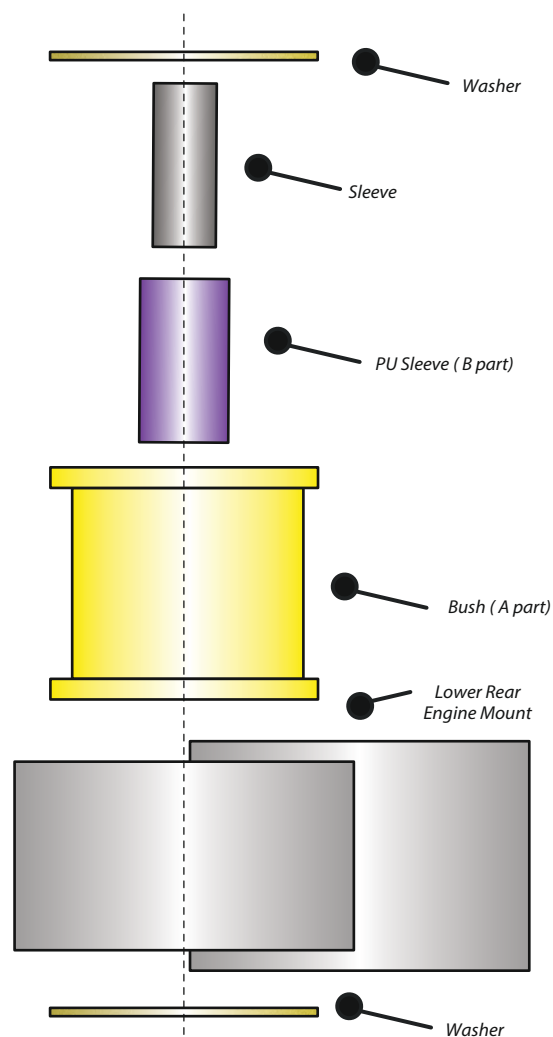

Figure 1